



**EC49/40 - AH-15 Unterteil - lower part**



Laserdesign:



Farbe | Color:

- .01. silver
- .02. black
- .03. white
- .04. red
- .05. blue
- .06. gold
- .07. orange
- .09. titan
- .11. green
- .12. brown
- .14. purple
- .15. turquo.

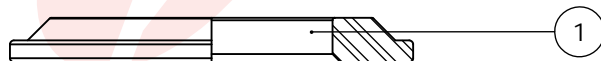
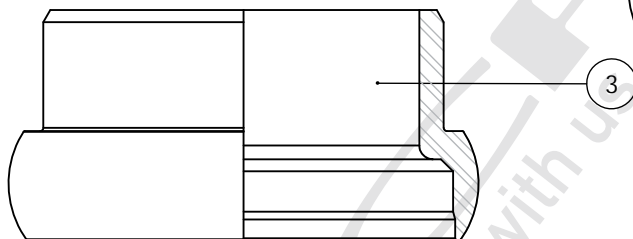
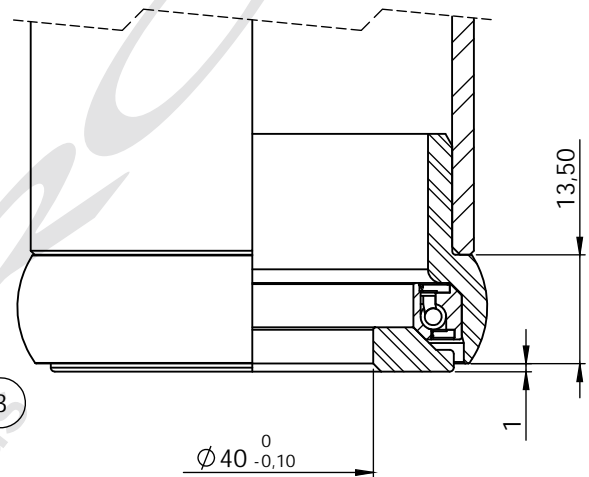
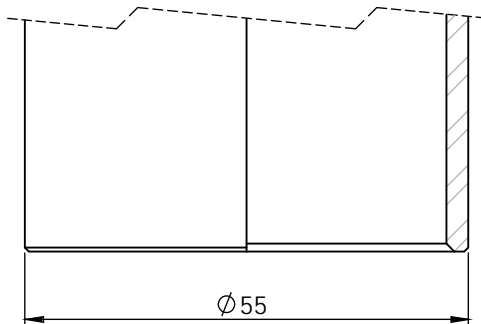

S.H.i.S.	S.H.i.S.	EC49/40
untere Bauhöhe	lower stack height	13,5 mm
Lager unten	lower bearing	S71808
EinpressØ Lagerschale	Ø cup skirt	49,65 mm
Einpresstiefe	cup skirt length	15,2 mm
Ø Lagerschale	Ø cup	59,5 mm
Ø Steuersatzboden	Ø base plate	39,8 mm

**AH-15 Unterteil / lower part - 15.02.601R3S**

POS	QTY	item No.	Art.Bez.	name of the item
	1	15.02.601R3S	Unterteil - EC49/40	lower headset type - EC49/40
1	1	51.01.002	Boden, AH-49 1.5"	base plate, AH-49 1.5"
2	1	SAC4052	Schrägkugellager Edelstahl 40x52x7	Stainless angular contact bearing
3	1	15.02.002R3	Lagerschale, AH-49 R3	bearing cup, AH-49 R3



# Gängige Kombinationen zum AH-49 Unterteil: Established combinations for AH-49 lower part:

## Oberteile / upper parts:

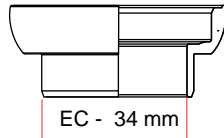

EC - 34 mm

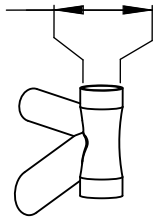

ø28,60

1 1/8" - 1.5"  
Tapered

- EC34/28.6 - Art. 16.02.605R3S - (Workbook S/p 17)

ø39,80mm

- EC34/28.6 Block Lock - Art. 52.02.605S (WB S/p 21)

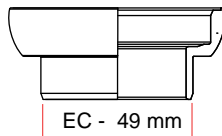

EC - 49 mm

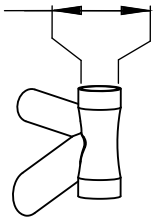

ø28,60

1 1/8" - 1.5"  
Tapered

- EC49/28.6 - Art. 17.02.605R2S - (Workbook S/p 29)

ø39,80mm

ø 38,10

1.5"

- EC 49/38.1 - Art. 15.02.605R3S - (Workbook S/p 29)

ø39,80mm



ZS - 44 mm

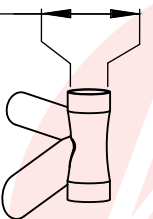

ø28,60

1 1/8" - 1.5"  
Tapered

- ZS44/28.6 - Art. 22.02.605R3S - (Workbook S/p 33)

ø39,80mm

- ZS44/28.6 BL - Art. 51.02.605S - (Workbook S/p 37)

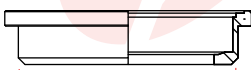

ZS - 49 mm

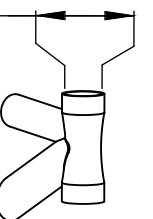

ø28,60

1 1/8"

- ZS 49/28.6 - Art. 25.02.605S - (Workbook S/p 39)

ø30mm